



PRODELINTM

A TriPoint Global Company

4096-275

REVISION B

February 15, 1994

ASSEMBLY INSTRUCTIONS

1.8M PEDESTAL MOUNT

**PRODELIN CORPORATION
1500 Prodelin Drive
Newton NC 28658 USA
828-464-4141**

1.8M PEDESTAL MOUNT

B	Revised Address	1/10/02	
A	ADDED 4" OD MAST.	02/15/94	RF
-	ORIGINAL RELEASE	07/24/91	
REV.	DESCRIPTION	DATE	APPROVED

GENERAL DESCRIPTION

This manual covers the installation of Prodelin's 1.8M Pedestal Mount for use with the 1.8M Antenna Systems. The manual describes the minimum foundation requirements for the 1.8M Pedestal Mount.

FOUNDATION REQUIREMENTS

The minimum foundation requirements are as follows:

1. The soil bearing capacity should be 2000 pounds per square foot at a minimum and the bottom of the foundation should be 6 inches below the local frost line.
2. Concrete should be poured against undisturbed soil.
3. All concrete should conform to building code standards and have a minimum compressive strength of 3000 pounds per square inch at 28 days (per ACI-318-77).
4. Allow concrete 24 hour set time before installation of antenna.
5. The minimum size and construction should be per Figure 1, see page 4.
6. There should be 10 - #5 x 42 inches long reinforcing bars positioned as shown in Figure 1, see page 4.

NOTE: Due to the wide variety of soil conditions, Prodelin Corporation does not warrant that any particular design or size of foundation is appropriate for any locality or earth station installation. It is the responsibility of the installer/user to determine if it meets the site/locality requirements. If there is any doubt have it checked by an architect or structural engineer.

INSTALLATION

1. Install a 5/8" hex nut and washer (item #3,4) on the anchor rod (item #6), then insert the anchor rod into one of the holes in the plywood template (item #7) and install another 5/8" hex nut and washer. Repeat this procedure for the remaining anchor rods. This will keep all of the anchor rods straight and in the proper orientation when the concrete is poured. Next, install two 5/8" hex nuts and the washer plate (item #2) on the other end of each anchor rod as shown in Figure 1, page 4.
2. Once the site location is determined, dig up the area where the foundation will be installed. Be careful not to dig too deep because the soil in the bottom and sides of the foundation should be undisturbed. Position the 10 #5 x 42" long reinforcing bars 9" apart as shown in Figure 1, page 4. Five of the reinforcing bars should face one direction and the other five are perpendicular to them. Position the anchor rods so that the washer plates are positioned under the reinforcing bars. Pour concrete and allow to dry for 24 hours.
3. Once the concrete is dry, remove the plywood template and screw the hex nuts as far down on the anchor rods as possible. Then install the mast pipe (item #1) onto the anchor rods. Adjust the lower hex nuts until the mast pipe is level in the vertical position. Reinstall the flatwashers and lockwashers and hex nuts. With the mast pipe tightened down, fill the space between the concrete slab and the mast pipe base with grout.

PARTS LIST FOR 1.8M PEDESTAL MOUNT			
1	0490-378	1.8M MAST PIPE (5.56 OD)	1
	OR 0490-471	OR 1.8M MAST PIPE (4.00 OD)	1
2	0156-534	WASHER PLATE	8
3	8105-007	5/8-11 HEX NUT	32
4	8201-044	5/8" FLAT WASHER	16
5	8102-044	5/8" LOCK WASHER	8
6	8500-009	5/8-11 x 18 GR5 ANCHOR ROD	8
7	0274-016	TEMPLATE, PLYWOOD	1

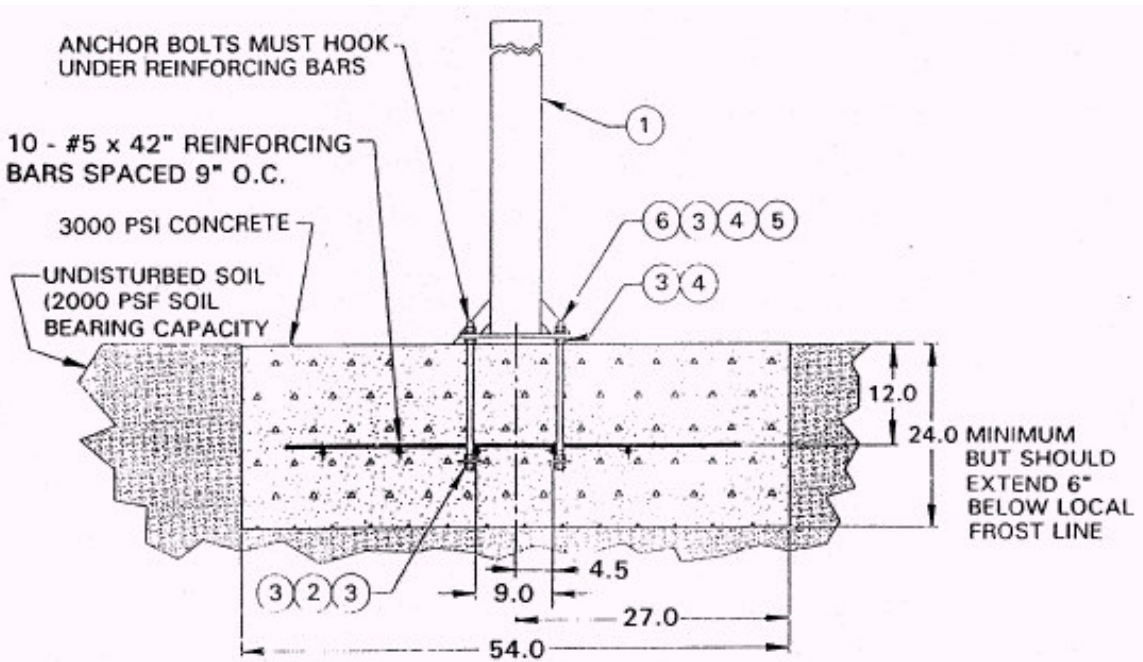

ALL DIMENSIONS ARE IN INCHES